

N

Location Plan

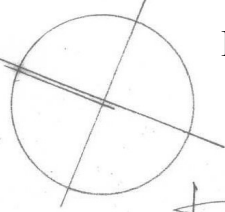

Isle of Bute

Kilmorye Bay

To Errick Bay

To Rothesay

Argyll and Bute Council
 This plan has been APPROVED by the PLANNING AUTHORITY and MUST be read in conjunction with the Planning Conditions of Consent No: 22/00330/PP
 Fergus Murray
 Head of Development and Economic Growth
 4 July 2022

Isle of Bute

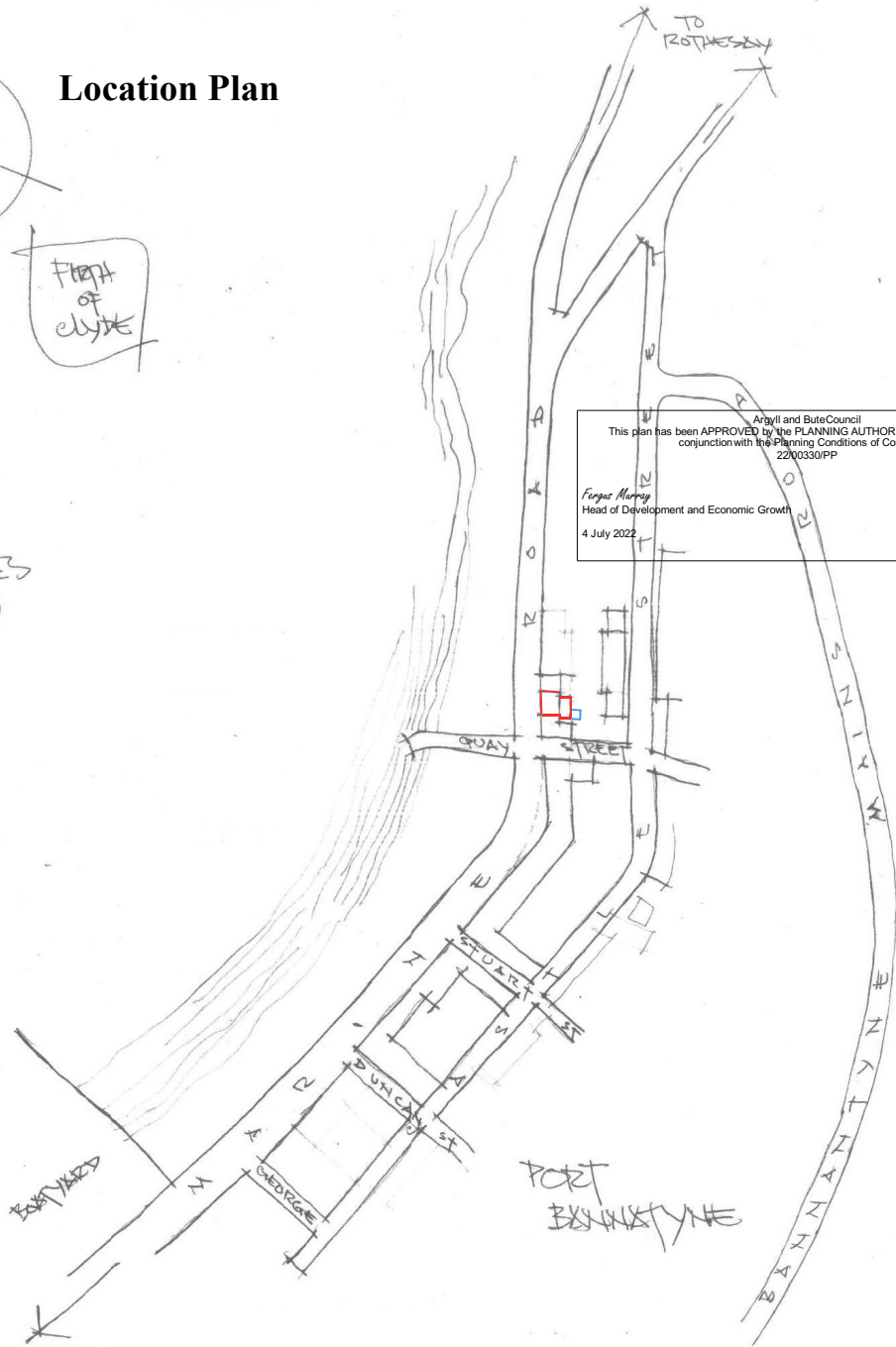

MARSHALL ASSOCIATES
 · A · R · C · H · I · T · E · C · T · S ·
 20A Argyle Street, Rothesay, Isle of Bute. PA20 0AU
 (01700) 504465

PROJECT





DRAWING
 LOCATION PLAN

--	--	--	--

Site Block Plan



Argyll and Bute Council
 This plan has been APPROVED by the PLANNING AUTHORITY and MUST be read in conjunction with the Planning Conditions of Consent No: 22/00330/PP
 Eileen Murray
 Head of Development and Economic Growth
 4 July 2022

-  Red = Original Building Extent
-  Blue = Outside Space (Not Licenced)
-  Black = Shared Access route
-  Green = Additional Internal Space added since 2022

MARSHALL ASSOCIATES
 ·A·R·C·H·I·T·E·C·T·S·
 20A Argyle Street, Rothesay, Isle of Bute. PA20 0AU
 (01700) 504465



PROJECT

DRAWING
 SITE BLOCK PLAN

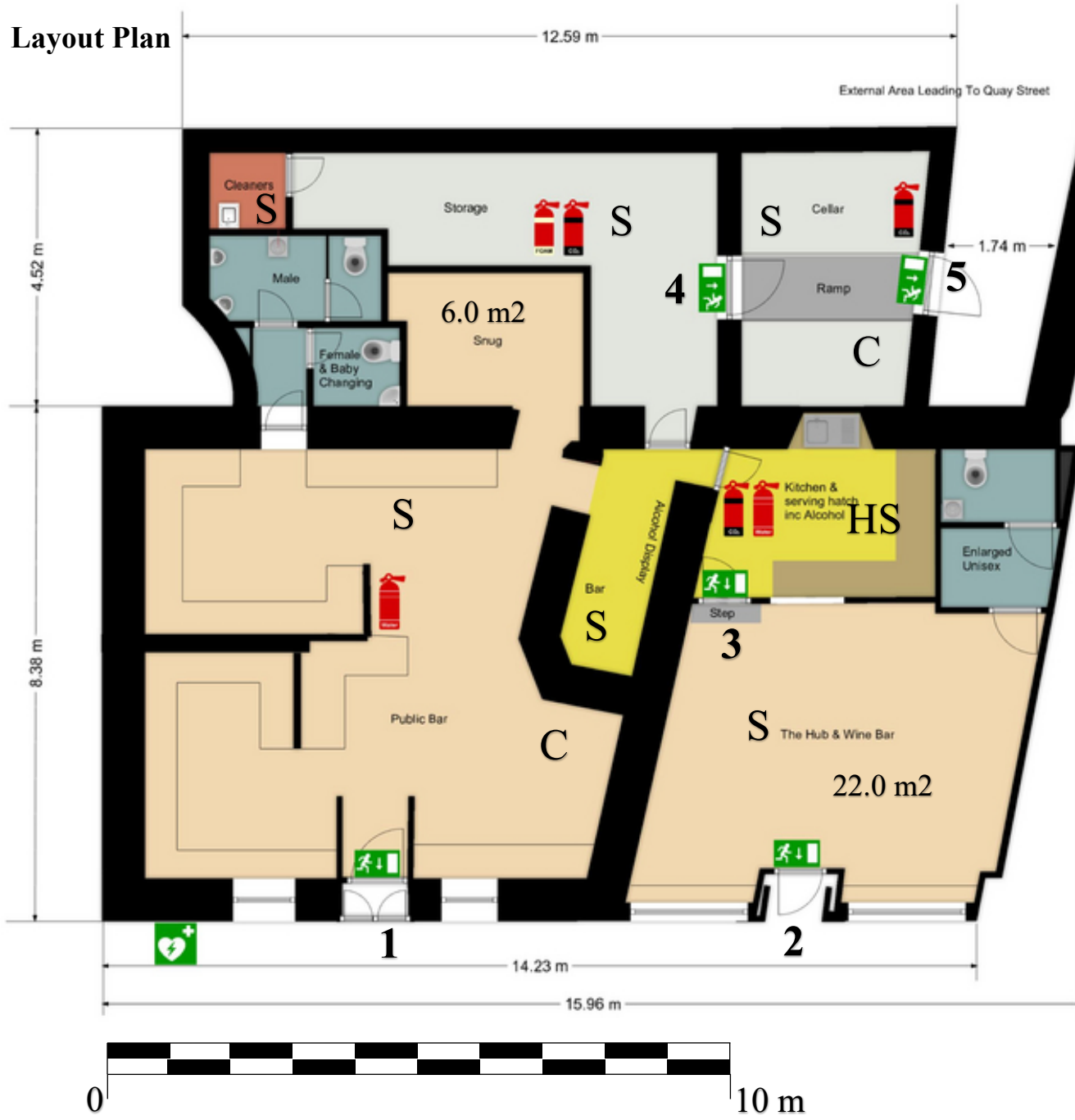
Layout Plan



Legend

-  = Foam Extinguisher
-  = CO2 Extinguisher
-  = Water Extinguisher

- S = Smoke Sensor
- HS = Heat & Smoke Sensor
- C = Carbon Monoxide Sensor

Opening Widths

- 1 = 750mm
- 2 = 838mm
- 3 = 838mm
- 4 = 950mm
- 5 = 1000mm

Alcohol Display (w x h) = 2.3m x 1.5m
(3.45 m2)